

Note:-

1. Panelling in all column.
2. Roller blinds in all area.
3. Metallic False ceiling in Toilet area.

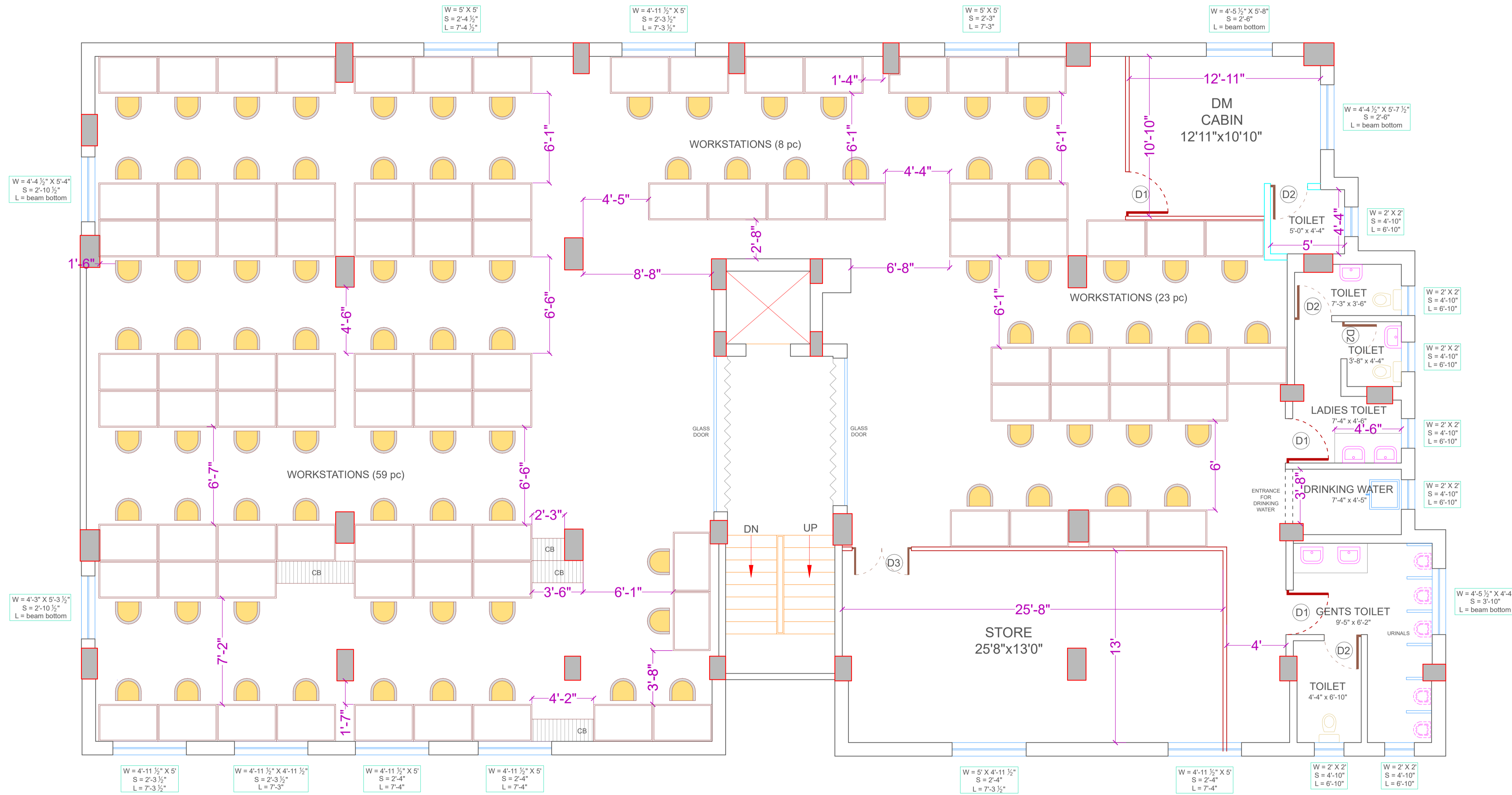

**CANARA BANK CPH
(FIRST FLOOR LAYOUT)**

**WORKSTATION-90 NOS.
STORE-348.00 SQ.FT**

SCHEDULE OF DOORS				
SL.NO.	WIDTH	SILL LVL.	HEIGHT	LINTEL LVL.
D1	3'-0"	00	7'-0"	7'-0"
D2	2'-6"	00	7'-0"	7'-0"
D3	4'-0"	00	7'-0"	7'-0"

SEATING CAPACITY DETAILS

WORKSTATIONS - 90 PERSONS

WORKSTATION TABLE SIZE - 4'-0" x 2'-6"

NOTE : All dimensions are in ft-inches

PROJECT
CANARA BANK CPH
AT BORING CANAL ROAD, PATNA

CLIENT
CANARA BANK

SHEET TITLE
**PROPOSED FIRST FLOOR
INTERIOR LAYOUT**

DRAWN BY NARSINGH	SCALE NTS
-----------------------------	---------------------

DRAWING NO. 04	DATE 05-05-2022
--------------------------	---------------------------

REVISION 1 : 12-05-2022
REVISION 2 : 17-05-2022
REVISION 3 : 18-05-2022
REVISION 4 : 20-05-2022

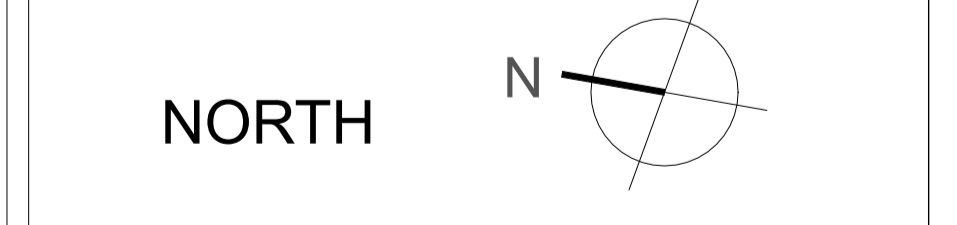

100-B Patliputra Colony .opp. P&M Mall,
Near Notre Dame Academy ,patna 800013
tel/fax: 0612-2267175/2275624
e: contact@kapoor.biz.web: www.kapoor.biz

k&a
kapoor and associates
ARCHITECTURE | INTERIOR DESIGN | URBAN DESIGN